

## DESCRIPTION

Fixed caliper with 4 opposed pistons, realized by semicalipers joined by bolts. Pads are supported by two pins. Construction Material: Aluminium Alloy. Operating fluid: brake fluid DOT4. N.B.: drawing shows left side caliper. Code 20.6800.15 Code 20.6800.25 specular. Mounting side behind the fork.

## PADS SHAPE AND DIMENSIONS

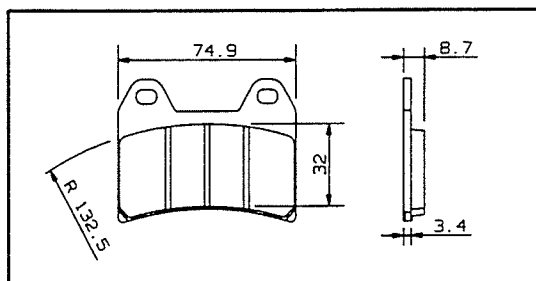

## TECHNICAL CHARACTERISTICS

Pistons number and diameter:	4 30/34mm	Average pad surface (1 pad):	21.3 cm <sup>2</sup>
MAX working pressure:	70bar	Weight (with not sintered pad):	1.090 Kg
A) Disc position (TOLERANCE):			
Disc thickness 5.0 mm	±0.8 mm		
Disc thickness 4.0 mm	±0.8 mm		

## CONFIGURATION

CODE CALIPER	CHARACT.	PADS FRICTION MATERIAL	BODY COLOR	MOUNT. SIDE	USABLE DISCS THICKNESS	BRAKE FLUID FOR PADS WEAR
20.6800.15 25		FERIT I/D 450 FF	BLACK	SX DX	5.0 mm 4.0 mm	16.15 cm <sup>3</sup>

## AVAILABLE SPARE PARTS

CODE CALIPER	SPARE PARTS	PADS	BLEEDER SCREW	DUST COVER	RETAINERS	PIN/RETAINER	PAD SPRING
20.6800.15 25		107.6708.10	105.3246.14	105.1502.10	105.4542.18	120.3942.30	120.2255.90