

Radial master cylinder mounting instructions

Thank you for purchasing this Moto-Master performance product. Please read these instructions carefully before attempting installation. *

Step 1

Remove existing master cylinder with brake line from the handle bar. Clean master cylinder mounting surface on the handle bar.

Avoid spilling brake fluid.

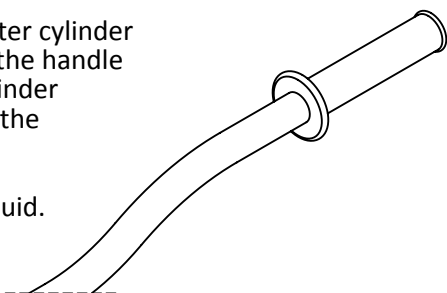

Step 2

Install the Moto-Master Radial Master Cylinder and make sure the bleeder nipple is positioned at the highest point. Level the brake fluid reservoir horizontally and fasten the bolt of the reservoir clamp. Do not over tighten the reservoir clamp bolt. The final angle of the master cylinder can be adjusted after bleeding.

Reservoir bolt torque: 3 Nm

Clamping screw torque: 6 Nm

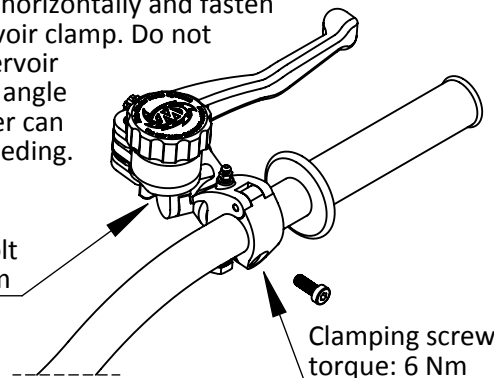

Step 3

Install brake line as depicted; Using the banjo bolt and placing the brake line fitting in between two copper washer rings.

Torque tighten the banjo bolt at 15Nm.

Banjo bolt torque: 15 Nm

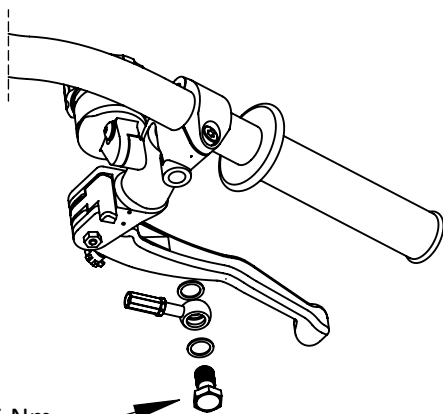

Step 4

Remove the filler-cap and seal. Fill the reservoir with new DOT 4 brake fluid or higher. Pump the brakes and keep the fluid level between Min and Max mark on the reservoir. Bleed the brake system of all air using the bleeding nipple on brake Caliper and Master Cylinder.

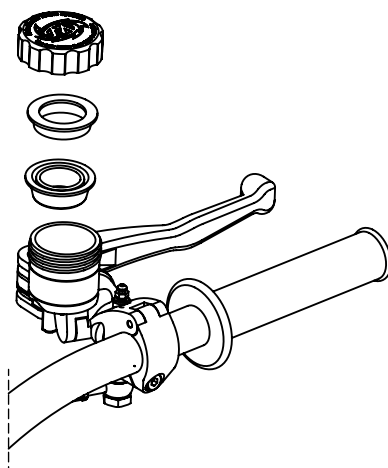

Step 5

Fine-tuning of the Master Cylinder:

Fill the reservoir

Level the reservoir (3 Nm)

Bleed the master cylinder (2 Nm)

Adjust the position of the brake lever

Adjust position and angle of master cylinder

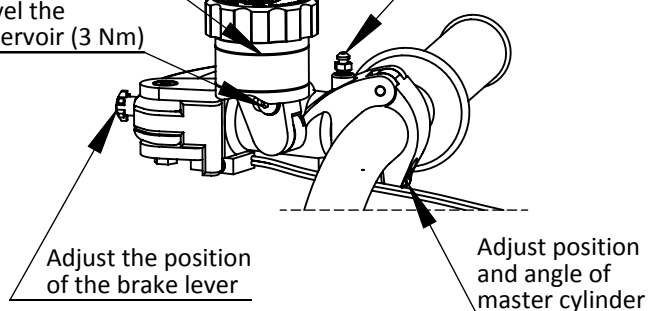

Spare parts and revision kits

Moto-Master offers spare parts and a revision kit to keep your Master Cylinder in perfect working condition. Check the product numbers of the available spare parts below;

213005 Radial master cylinder revision kit 12mm

- 213061 Lever [black]
- 213001 Lever [chrome]
- 213008 Pressure pin
- 213009 Bleeder nipple
- 213060 Brake fluid reservoir [smoke] (excl. cap)
- 213006 Brake fluid reservoir [white] (excl. cap)
- 213010 Reservoir cap [black]
- 213003 Reservoir cap [orange]
- 213002 Brake light switch
- 213017 Single banjo bolt (incl. 2x copper washer)
- 213007 Double banjo bolt (incl. 3x copper washer)

Optional

Install 213002 brake light switch using the screws supplied in the kit. Make sure to position the switch contact against the lever.

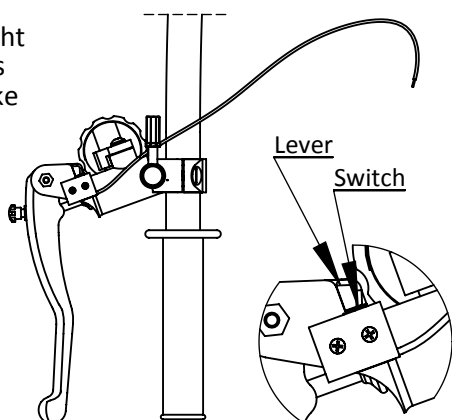

*Consult a certified dealer or professional mechanic if you are not fully qualified in motorcycle maintenance. Moto-Master cannot be held responsible for any damage or injury caused by incorrect product mounting, disregarding specifications and these instructions, or product mounting by an unqualified third party.



For more info, check:

WWW.MOTO-MASTER.COM

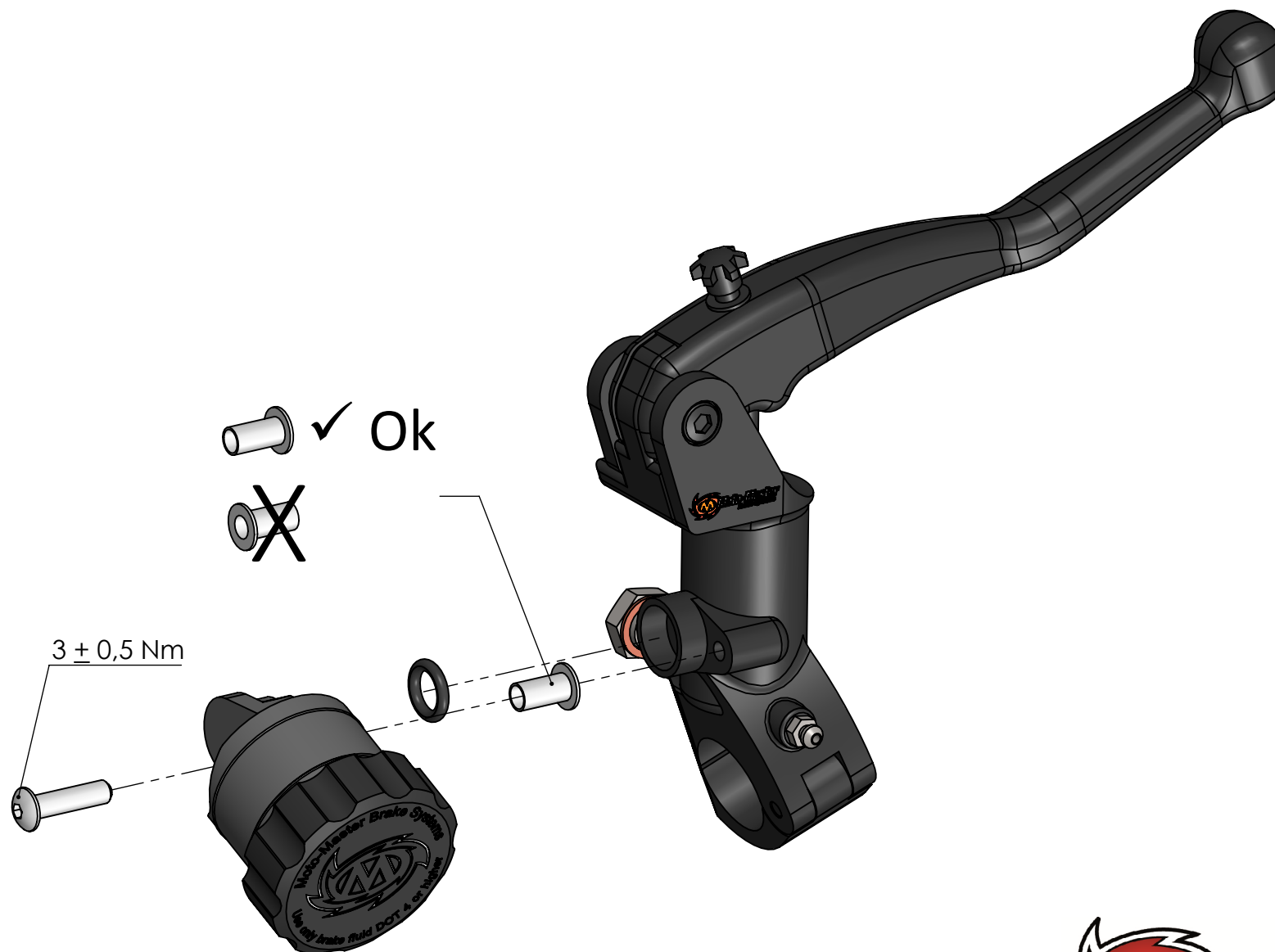

For more info, check:

WWW.MOTO-MASTER.COM/DOWNLOADS