

DESCRIPTION

Fixed caliper with 2 opposed pistons, realized by semicalipers joined by bolts. Pads are supported by one pin. Construction Material: Aluminium Alloy. Operating fluid: brake fluid DOT4.

PADS SHAPE AND DIMENSIONS

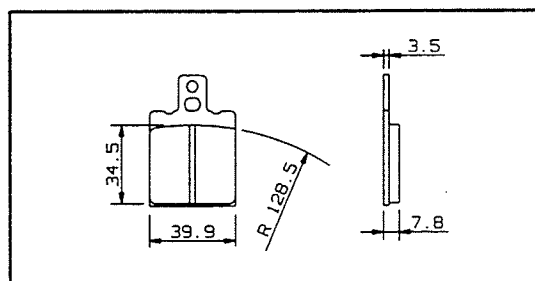

TECHNICAL CHARACTERISTICS

Pistons number and diameter:	2	32mm	Average pad surface (1 pad):	13.3 cm²
MAX working pressure:		100bar	Weight (with not sintered pad):	0.540 Kg
A) Disc position (TOLERANCE):				
Disc thickness	5.0 mm	±0.1 mm		
Disc thickness	4.6/4.0 mm	±0.3 mm		

CONFIGURATION

CHARACT. CODE CALIPER	PADS FRICTION MATERIAL	BODY COLOR	MOUNT. SIDE	USABLE DISCS THICKNESS	BRAKE FLUID FOR PADS WEAR
20.5161.43	FERIT I/D 450 FF	GOLD	SX DX	5.0 mm 4.6 mm 4.0 mm	6.60 cm³

AVAILABLE SPARE PARTS

SPARE PARTS CODE CALIPER	PADS	BLEEDER SCREW	DUST COVER	PIN
20.5161.43	107.2686.42	105.3246.11	105.1502.10	120.2800.11